

FRESA PARA PUNZÓN CUELLO BOTELLA RFPA ENDMILL FOR BOTTLE-NECK PUNCH RFPA

Material: 1.3343 HSS

Dureza / Hardness: 64±2 HRC

Fresa para alojamiento cabeza punzón RPX_.

Endmill for making holes for RPX_ punches.

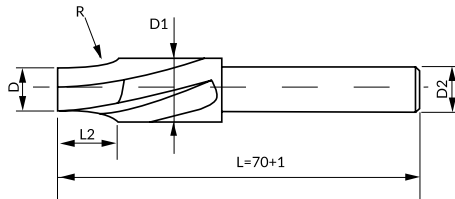

D ^{f7}	D1 ^{h8}	D2 ^{h11}	R ^{+0,01 0}	L2
5	7,4	7,4	10	10
6	9,5	9,5	10	10
8	11,5	11,5	12	12
10	14,5	13	15	12
13	17,5	13	15	15
16	20,5	13	15	15
20	25,5	16	15	15

How to order: RFPA + D