

# CILINDRO M GAS SPRING M

STOCK

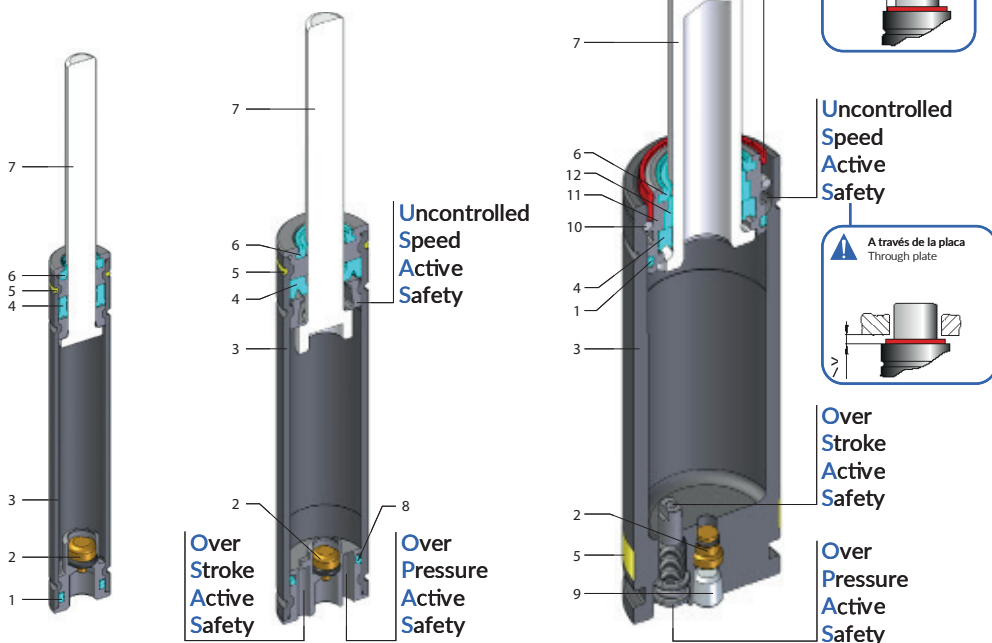

M 50 - M 70

M 90 - M 200

M 300

Standard: VDI

Model	Body Ø	Stroke Cu	Initial force F0	OSAS	USAS	OPAS	SKUDO	SW (optional)
	mm	mm	daN					
M50	12	7 - 125	6 - 50	-	-	-	-	•
M70	15	7 - 125	8 - 70	-	-	-	-	•
M90	19	7 - 125	5 - 90	•	•	•	-	•
M200	25	7 - 125	17 - 200	•	•	•	-	•
M300	32	7 - 125	80 - 320	•	•	-	-	•

1	Anillo dual / Dual ring seal
2	Válvula / Valve
3	Cuerpo / Body
4	Retén / Rod seal
5	Código de color de fuerza / Force color code
6	Retén / Rod wiper
7	Vástago (Nitrurado) / Rod (Nitrited Super finished)
8	Anillo-O / O-ring
9	Tapón / Stopper
10	Anillo de retención / Retaining ring
11	Casquillo / Bush
12	Anillo guía / Guide ring

## CILINDRO M GAS SPRING M

Versiones disponibles  
Available versions

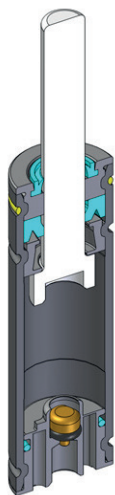

Standard code



Cilindro  
GAS SPRING

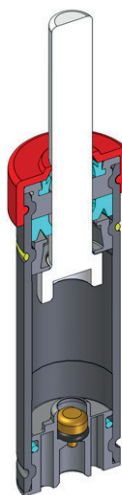

Standard code + W



Cilindro  
GAS SPRING  
+  
Rascador secundario  
Secondary wiper



See p. Ct163

# CILINDRO M 300 GAS SPRING M 300



SW

Active safety



OSAS



USAS

\*  $F_{1_i}$  =  
Isothermal end  
force at 100% Cu

\*  $F_{1_p}$  =  
Polytrophic end  
force at 100% Cu

Linkable with hoses

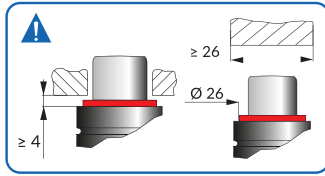

Assembly recommendation

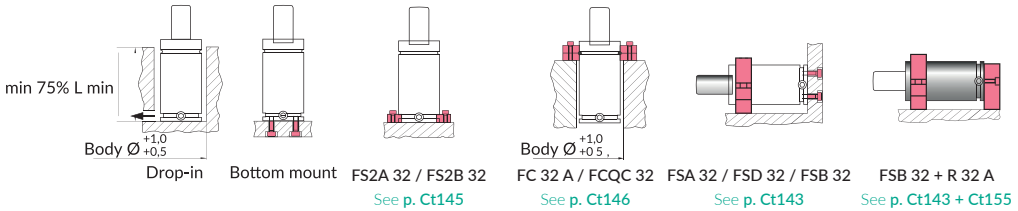
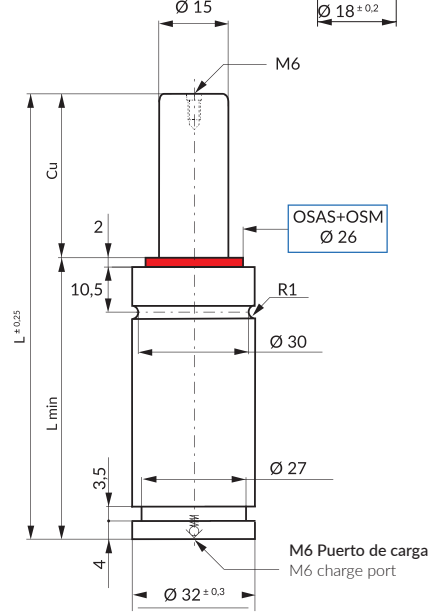
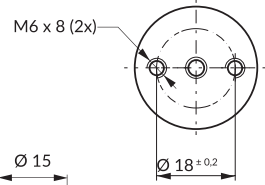

		$\Delta P$ ± 0,33 % / °C	P max 180 bar	P min 10 bar	S 1,77 cm <sup>2</sup>	SPM ~50 -80 (at 20°)	Max Speed 1,8 m/s	Maintenance kit Not available
--	--	-----------------------------	------------------	-----------------	---------------------------	----------------------------	----------------------	----------------------------------

Code	Cu	L	L min	F0 Initial force	F <sub>1</sub> End force*	V0	
	mm	mm	mm	daN	daN	cm <sup>3</sup>	
M300 007	7	56	49	1,20 x F0	1,35 x F0	8,3	0,21
M300 010	10	62	52	1,24 x F0	1,41 x F0	10,1	0,22
M300 013	12,7	67,4	54,7	1,27 x F0	1,46 x F0	11,7	0,23
M300 015	15	72	57	1,29 x F0	1,49 x F0	13,1	0,24
M300 025	25	92	67	1,35 x F0	1,58 x F0	19,1	0,26
M300 038	38	118	80	1,38 x F0	1,64 x F0	26,9	0,30
M300 050	50	142	92	1,40 x F0	1,67 x F0	34,1	0,34
M300 063	63,5	172	108,5	1,40 x F0	1,66 x F0	43,8	0,39
M300 080	80	205	125	1,41 x F0	1,69 x F0	53,7	0,44
M300 100	100	245	145	1,43 x F0	1,71 x F0	65,8	0,50
M300 125	125	295	170	1,44 x F0	1,73 x F0	80,8	0,57

P = Nominal charging pressure

Force color code	P	F0 Initial force ± 5%   +20°C
	bar	daN
GR	45	80
BU	90	160
RD	135	240
YW	180	320
BK	10-180	18-320

How to order: Code + Force color code