

CILINDRO RV GAS SPRING RV

Mínima altura, máxima fuerza / Minimum height, maximum force

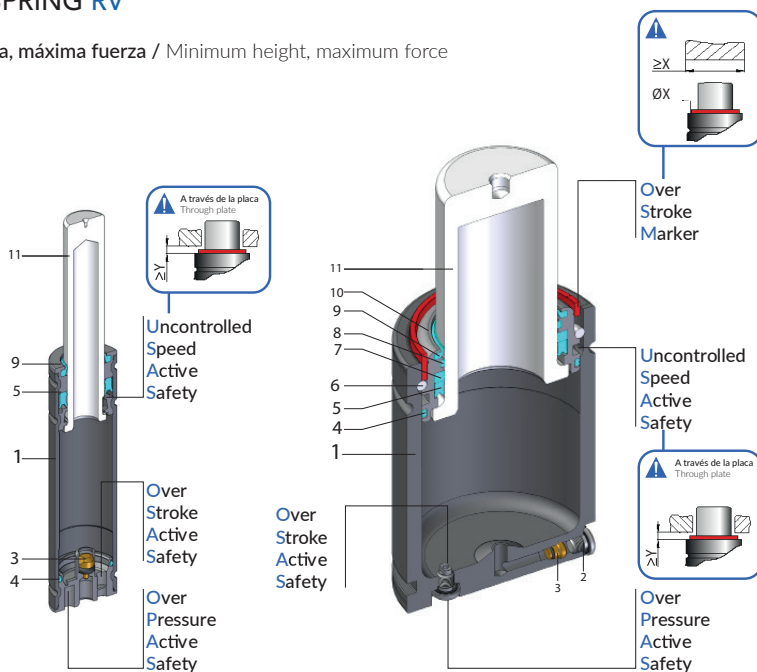

RV 170 - RV 320

RV 350 ÷ RV 20000

Standard: ISO, VDI

Model	Body Ø	Stroke Cu	Initial force F0	OSAS	USAS	OPAS	SKUDO	SW (optional)
	mm	mm	daN					
RV 170	19	7 - 125	170	•	•	•	-	•
RV 320	25	7 - 125	320	•	•	•	-	•
RV350	32	10 - 125	360	•	•	•	-	•
RV 500	38	10 - 125	470	•	•	•	-	•
RV 750	45	10 - 125	740	•	•	•	-	•
RV 1000	50	10 - 125	920	•	•	•	-	•
RV 1200	50	10 - 125	1060	•	•	•	-	•
RV 1500	63	10 - 125	1530	•	•	•	-	•
RV 2400	75	10 - 125	2385	•	•	•	-	•
RV 4200	95	16 - 125	4240	•	•	•	-	•
RV 6600	120	16 - 125	6630	•	•	•	-	•
RV 9500	150	19 - 125	9540	•	•	•	-	•
RV 12000	150	19 - 125	11780	•	•	•	-	•
RV 20000	195	19 - 125	19910	•	•	•	-	•

1	Cuerpo / Body
2	Válvula / Valve
3	Tapón / Plug
4	Anillo dual / Dual ring seal
5	Casquillo guía / Guide ring
6	Anillo de retención / Retaining ring

7	Retén / Rod seal
8	Anillo antiextrusión / Back-up ring
9	Rascador / Rod wiper
10	Casquillo / Bush
11	Vástago (niturado) / Rod (nitrited super finished)

CILINDRO RV
GAS SPRING RV

Versiones disponibles / Available versions

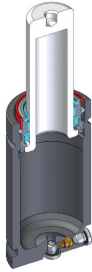

Standard code



GAS SPRING

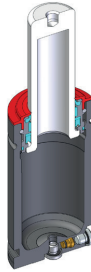

Standard code + W



GAS SPRING
+
Secondary wiper



See p. Ct163

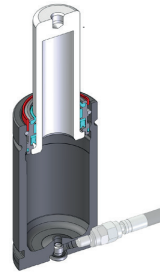

Standard code + N



Linkable
See p. Ct157

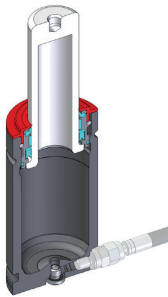

Standard code + N-W



Linkable
+
Secondary wiper



See p. Ct157 + Ct163

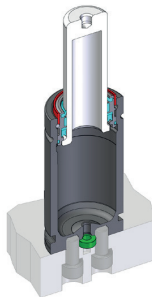

Standard code + E



Easy Manifold



See p. Ct158

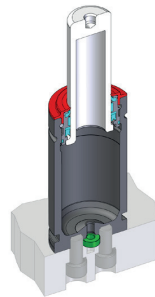

CILINDRO RV 1000 GAS SPRING RV 1000



SW

Active safety



OSAS



USAS



OPAS

* F₁ = Isothermal end force at 100% Cu

* F_{1p} = Polytrophic end force at 100% Cu

OSAS + OSM = OVER STROKE + OVER STROKE ACTIVE SAVERY

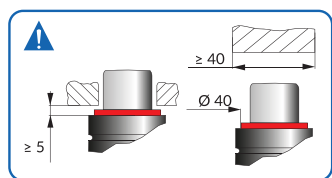

Assembly recommendation

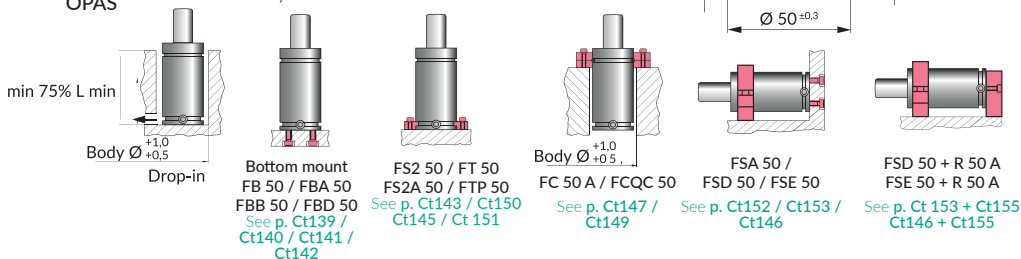

Standard: ISO 11901-3, VDI 3003-Blatt 3

		ΔP	P max	P min	S	SPM	Max Speed	Maintenance kit
N ₂	0 - 80°C	± 0,33 % / °C	150 bar	20 bar	6,15 cm ²	~20 -100 (at 20°)	1,8 m/s	39BMRV01000C

Code	Cu	L	L min	F0 Initial force daN	F ₁ End force* daN	F _{1p} End force* daN	V0 cm ³		PED 2014/68/EU
	mm	mm	mm						
RV 1000-010	10	58	48	920 ± 5% 150bar +20°C	1321	1554	23,7	0,49	•
RV 1000-013	13	64	51		1370	1631	28,4	0,51	•
RV 1000-016	16	70	54		1407	1690	33,1	0,54	•
RV 1000-019	19	76	57		1436	1737	37,7	0,56	•
RV 1000-025	25	88	63		1479	1807	47,1	0,61	•
RV 1000-032	32	102	70		1514	1863	58	0,67	•
RV 1000-038	38	114	76		1535	1897	67,4	0,72	•
RV 1000-050	50	138	88		1564	1946	86,1	0,81	•
RV 1000-063	63	164	101		1585	1981	106,3	0,92	•
RV 1000-075	75	188	113		1599	2003	125	1,01	•
RV 1000-080	80	198	118		1603	2011	132,8	1,05	•
RV 1000-100	100	238	138		1618	2034	164	1,21	•
RV 1000-125	125	288	163	1629	2054	202,9	1,41	•	

How to order: Code