

CILINDRO RV GAS SPRING RV

Mínima altura, máxima fuerza / Minimum height, maximum force

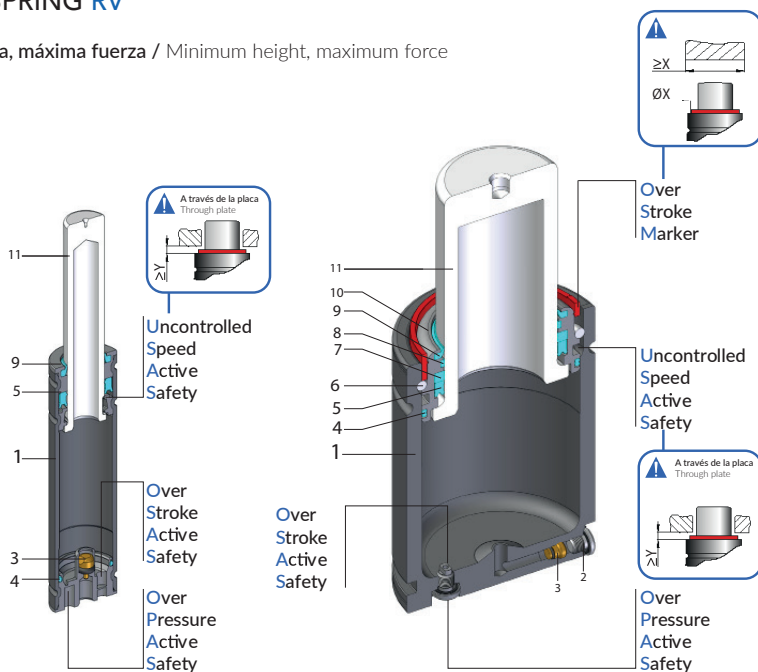

RV 170 - RV 320

RV 350 ÷ RV 20000

Standard: ISO, VDI

Model	Body Ø	Stroke Cu	Initial force F0	OSAS	USAS	OPAS	SKUDO	SW (optional)
	mm	mm	daN					
RV 170	19	7 - 125	170	•	•	•	-	•
RV 320	25	7 - 125	320	•	•	•	-	•
RV350	32	10 - 125	360	•	•	•	-	•
RV 500	38	10 - 125	470	•	•	•	-	•
RV 750	45	10 - 125	740	•	•	•	-	•
RV 1000	50	10 - 125	920	•	•	•	-	•
RV 1200	50	10 - 125	1060	•	•	•	-	•
RV 1500	63	10 - 125	1530	•	•	•	-	•
RV 2400	75	10 - 125	2385	•	•	•	-	•
RV 4200	95	16 - 125	4240	•	•	•	-	•
RV 6600	120	16 - 125	6630	•	•	•	-	•
RV 9500	150	19 - 125	9540	•	•	•	-	•
RV 12000	150	19 - 125	11780	•	•	•	-	•
RV 20000	195	19 - 125	19910	•	•	•	-	•

1	Cuerpo / Body
2	Válvula / Valve
3	Tapón / Plug
4	Anillo dual / Dual ring seal
5	Casquillo guía / Guide ring
6	Anillo de retención / Retaining ring

7	Retén / Rod seal
8	Anillo antiextrusión / Back-up ring
9	Rascador / Rod wiper
10	Casquillo / Bush
11	Vástago (nitrurado) / Rod (nitrited super finished)

CILINDRO RV
GAS SPRING RV

Versiones disponibles / Available versions

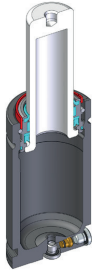

Standard code



GAS SPRING

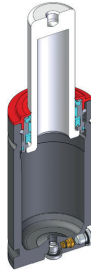

Standard code + W



GAS SPRING
+
Secondary wiper



See p. Ct163

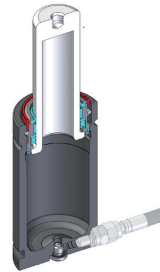

Standard code + N



Linkable
See p. Ct157

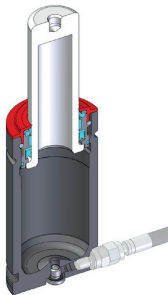

Standard code + N-W



Linkable
+
Secondary wiper



See p. Ct157 + Ct163

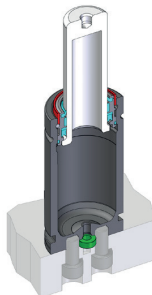

Standard code + E



Easy Manifold



See p. Ct158

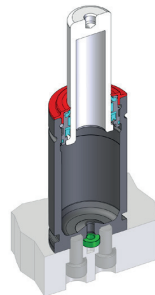

CILINDRO RV 1200 GAS SPRING RV 1200



SW

Active safety



OSAS



USAS



OPAS

* F_{1i} =
Isothermal end
force at 100% Cu

* F_{1p} =
Polytropic end
force at 100% Cu

OSAS + OSM = OVER STROKE + OVER STROKE ACTIVE SAVETY MARKER

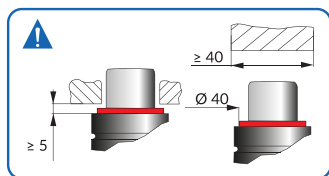

Assembly recommendation

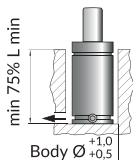
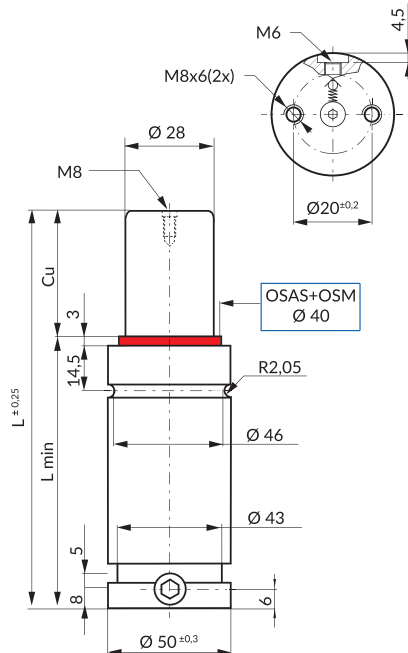

Drop-in

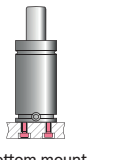

Bottom mount
FB 50 - FBA 50
FBB 50 - FBD 50
See p. Ct139 / Ct140 / Ct141 / Ct142

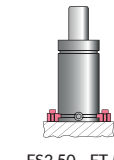

FS2 50 - FT 50
FS2A 50 - FTP 50
See p. Ct143 / Ct150 / Ct145 / Ct 151

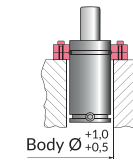

See p. Ct147 / Ct149

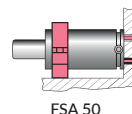

FSA 50
FSD 50 - FSE 50
See p. Ct152 / Ct153 / Ct146

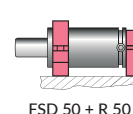

See p. Ct 153 + Ct155 / Ct146 + Ct155

		ΔP ± 0,33 % / °C	P max 170 bar	P min 20 bar	S 6,15 cm ²	SPM ~20 -100 (at 20°)	Max Speed 1,8 m/s	Maintenance kit 39BMRV01000C
--	--	-----------------------------	------------------	-----------------	---------------------------	-----------------------------	----------------------	---------------------------------

Code	Cu	L	L min	FO Initial force	F_{1i} End force*	F_{1p} End force*	V0		PED 2014/68/EU
	mm	mm	mm	daN	daN	daN	cm ³		
RV 1200-010	10	58	48	1060 ± 5% 170bar +20°C	1519	1752	23,7	0,49	•
RV 1200-013	13	64	51		1577	1839	28,4	0,51	•
RV 1200-016	16	70	54		1622	1906	33,1	0,54	•
RV 1200-019	19	76	57		1657	1959	37,7	0,56	•
RV 1200-025	25	88	63		1709	2037	47,1	0,61	•
RV 1200-032	32	102	70		1750	2100	58	0,67	•
RV 1200-038	38	114	76		1776	2139	67,4	0,72	•
RV 1200-050	50	138	88		1811	2194	86,1	0,81	•
RV 1200-063	63	164	101		1836	2233	106,3	0,92	•
RV 1200-075	75	188	113		1853	2258	125	1,01	•
RV 1200-080	80	198	118	1858	2267	132,8	1,05	•	
RV 1200-100	100	238	138	1875	2293	164	1,21	•	
RV 1200-125	125	288	163	1889	2315	202,9	1,41	•	

How to order: Code