

## CILINDRO RV GAS SPRING RV

Mínima altura, máxima fuerza / Minimum height, maximum force

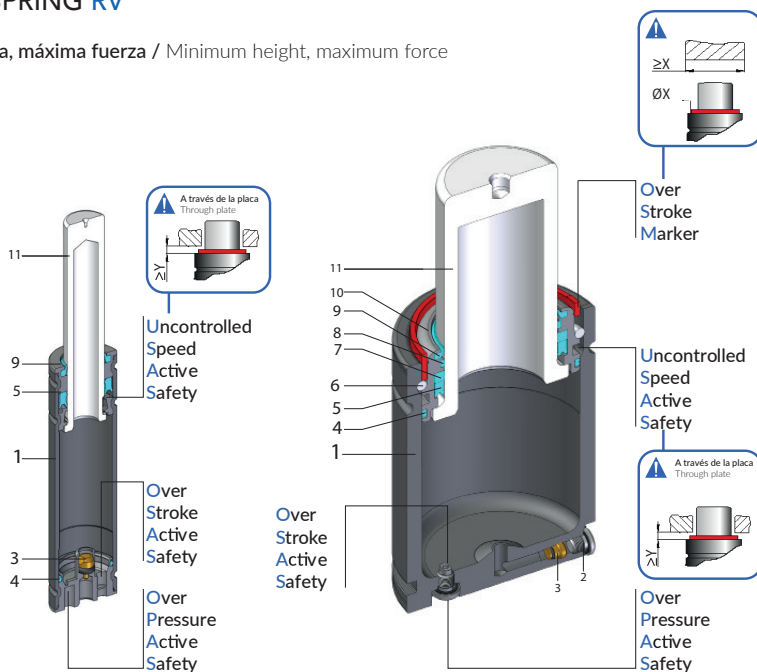

RV 170 - RV 320

RV 350 ÷ RV 20000

Standard: ISO, VDI

Model	Body $\varnothing$	Stroke Cu	Initial force F0	OSAS	USAS	OPAS	SKUDO	SW (optional)
	mm	mm	daN					
RV 170	19	7 - 125	170	•	•	•	-	•
RV 320	25	7 - 125	320	•	•	•	-	•
RV350	32	10 - 125	360	•	•	•	-	•
RV 500	38	10 - 125	470	•	•	•	-	•
RV 750	45	10 - 125	740	•	•	•	-	•
RV 1000	50	10 - 125	920	•	•	•	-	•
RV 1200	50	10 - 125	1060	•	•	•	-	•
RV 1500	63	10 - 125	1530	•	•	•	-	•
RV 2400	75	10 - 125	2385	•	•	•	-	•
RV 4200	95	16 - 125	4240	•	•	•	-	•
RV 6600	120	16 - 125	6630	•	•	•	-	•
RV 9500	150	19 - 125	9540	•	•	•	-	•
RV 12000	150	19 - 125	11780	•	•	•	-	•
RV 20000	195	19 - 125	19910	•	•	•	-	•

1	Cuerpo / Body
2	Válvula / Valve
3	Tapón / Plug
4	Anillo dual / Dual ring seal
5	Casquillo guía / Guide ring
6	Anillo de retención / Retaining ring

7	Retén / Rod seal
8	Anillo antiextrusión / Back-up ring
9	Rascador / Rod wiper
10	Casquillo / Bush
11	Vástago (niturado) / Rod (nitrited super finished)

CILINDRO RV  
GAS SPRING RV

Versiones disponibles / Available versions

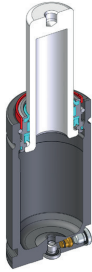

Standard code



GAS SPRING

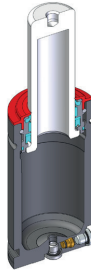

Standard code + W



GAS SPRING  
+  
Secondary wiper



See p. Ct163

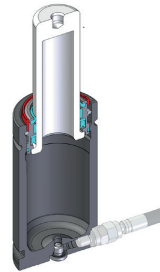

Standard code + N



Linkable  
See p. Ct157

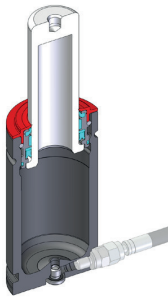

Standard code + N-W



Linkable  
+  
Secondary wiper



See p. Ct157 + Ct163

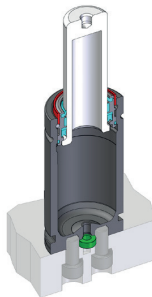

Standard code + E



Easy Manifold



See p. Ct158

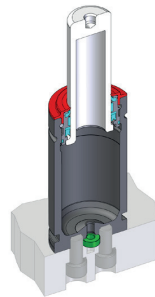

**CILINDRO RV 320**  
**GAS SPRING RV 320**



SW  
Active safety

\* F<sub>1i</sub> =  
Isothermal end  
force at 100% Cu

\* F<sub>1p</sub> =  
Polytropic end  
force at 100% Cu



Linkable with hoses

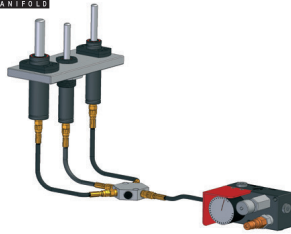

Assembly recommendation

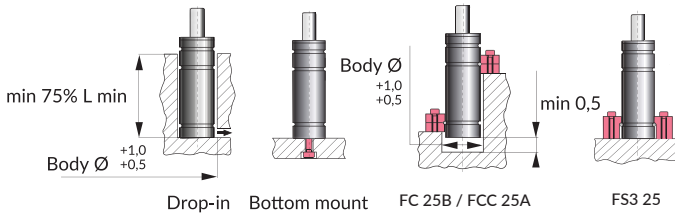
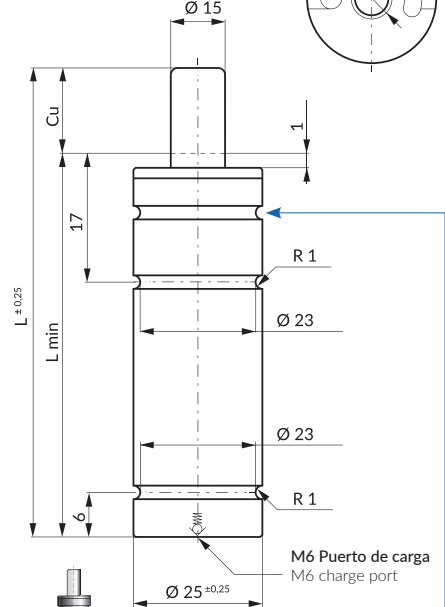
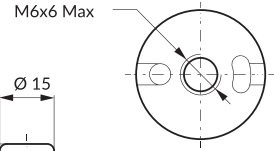

**!** Not for mounting

		$\Delta P$	P max	P min	S	SPM	Max Speed	Maintenance kit
N <sub>2</sub>	0 - 80°C	± 0,33 % / °C	180 bar	20 bar	1,77 cm <sup>2</sup>	~40 -100 (at 20°)	1,8 m/s	Not available

Code	Cu	L	L min	F0 Initial force daN	F <sub>1i</sub> End force* daN	F <sub>1p</sub> End force* daN	V0		PED 2014/06/EU
	mm	mm	mm						
RV 320-007	7	44	37	320 ± 5% 180bar +20°C	471	540	4,6	0,10	•
RV 320-010	10	50	40		495	574	6	0,10	•
RV 320-013	13	56	43		511	598	7,3	0,11	•
RV 320-015	15	60	45		519	610	8,2	0,11	•
RV 320-019	19	68	49		531	628	10,1	0,12	•
RV 320-025	25	80	55		544	647	12,8	0,13	•
RV 320-032	32	94	62		553	661	15,9	0,14	•
RV 320-038	38	106	68		559	669	18,6	0,15	•
RV 320-050	50	130	80		567	681	24,1	0,17	•
RV 320-063	63	156	93		572	689	29,9	0,19	•
RV 320-075	75	185	110		570	686	35,8	0,22	•
RV 320-080	80	195	115		572	688	38,1	0,23	•
RV 320-100	100	235	135		576	695	47,1	0,26	•
RV 320-125	125	285	160		580	700	58,4	0,30	•

How to order: Code