

## CILINDRO RV GAS SPRING RV

Mínima altura, máxima fuerza / Minimum height, maximum force

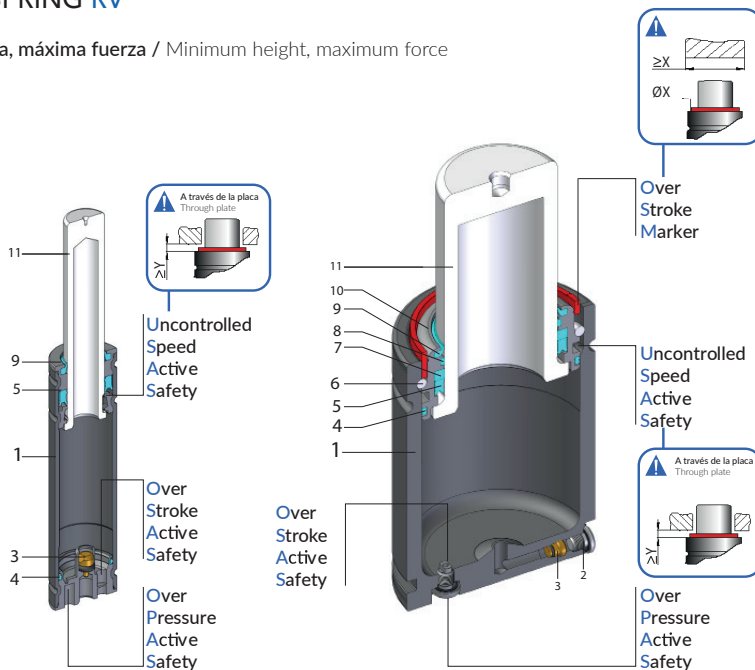

RV 170 - RV 320

RV 350 ÷ RV 20000

Standard: ISO, VDI

| Model    | Body $\varnothing$ | Stroke Cu | Initial force F0 | OSAS | USAS | OPAS | SKUDO | SW (optional) |
|----------|--------------------|-----------|------------------|------|------|------|-------|---------------|
|          | mm                 | mm        | daN              |      |      |      |       |               |
| RV 170   | 19                 | 7 - 125   | 170              | •    | •    | •    | -     | •             |
| RV 320   | 25                 | 7 - 125   | 320              | •    | •    | •    | -     | •             |
| RV350    | 32                 | 10 - 125  | 360              | •    | •    | •    | -     | •             |
| RV 500   | 38                 | 10 - 125  | 470              | •    | •    | •    | -     | •             |
| RV 750   | 45                 | 10 - 125  | 740              | •    | •    | •    | -     | •             |
| RV 1000  | 50                 | 10 - 125  | 920              | •    | •    | •    | -     | •             |
| RV 1200  | 50                 | 10 - 125  | 1060             | •    | •    | •    | -     | •             |
| RV 1500  | 63                 | 10 - 125  | 1530             | •    | •    | •    | -     | •             |
| RV 2400  | 75                 | 10 - 125  | 2385             | •    | •    | •    | -     | •             |
| RV 4200  | 95                 | 16 - 125  | 4240             | •    | •    | •    | -     | •             |
| RV 6600  | 120                | 16 - 125  | 6630             | •    | •    | •    | -     | •             |
| RV 9500  | 150                | 19 - 125  | 9540             | •    | •    | •    | -     | •             |
| RV 12000 | 150                | 19 - 125  | 11780            | •    | •    | •    | -     | •             |
| RV 20000 | 195                | 19 - 125  | 19910            | •    | •    | •    | -     | •             |

|   |                                      |
|---|--------------------------------------|
| 1 | Cuerpo / Body                        |
| 2 | Válvula / Valve                      |
| 3 | Tapón / Plug                         |
| 4 | Anillo dual / Dual ring seal         |
| 5 | Casquillo guía / Guide ring          |
| 6 | Anillo de retención / Retaining ring |

|    |  |
|----|--|
| 7  | Retén / Rod seal                                   |
| 8  | Anillo antiextrusión / Back-up ring                |
| 9  | Rascador / Rod wiper                               |
| 10 | Casquillo / Bush                                   |
| 11 | Vástago (nitruado) / Rod (nitrited super finished) |

CILINDRO RV  
GAS SPRING RV

Versiones disponibles / Available versions

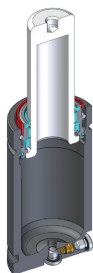

Standard code



GAS SPRING

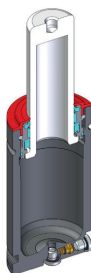

Standard code + W



GAS SPRING  
+  
Secondary wiper



See p. Ct163

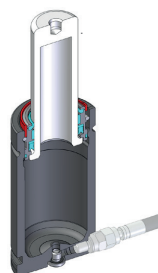

Standard code + N



Linkable  
See p. Ct157

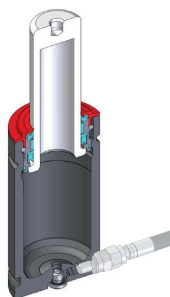

Standard code + N-W



Linkable  
+  
Secondary wiper



See p. Ct157 + Ct163

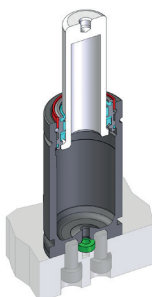

Standard code + E



Easy Manifold



See p. Ct158

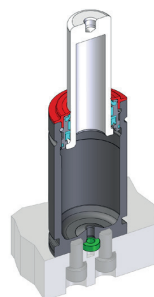

# CILINDRO RV 6600

## GAS SPRING RV 6600



SW

Active safety



OSAS



USAS



OPAS

\*  $F_{1i}$  = Isothermal end force at 100% Cu\*  
 $F_{1p}$  = Polytrophic end force at 100% Cu

**OSAS + OSM** = OVER STROKE ACTIVE SAVETY + OVER STROKE MARKER

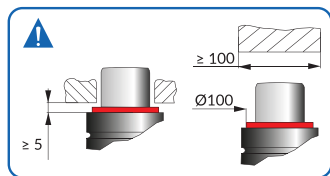

Assembly recommendation

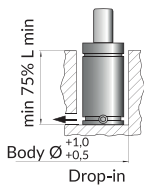
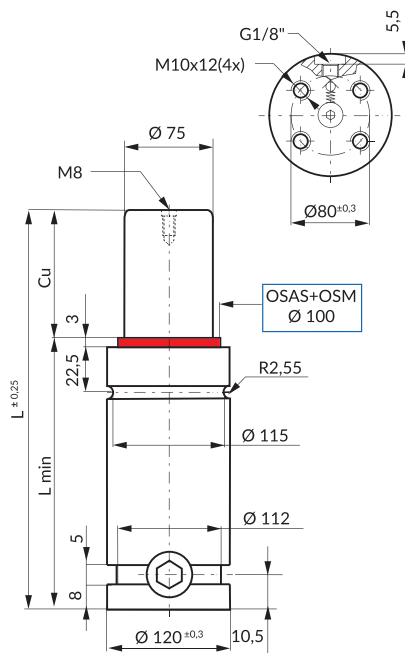

Drop-in

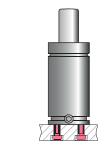

Bottom mount  
 FB 120 - FBA 120  
 FBB 120

See p. Ct139 / Ct140 / Ct141

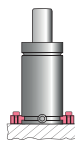

FS2 120-FT 120  
 FS2A 120-FTP 120

See p. Ct143 / Ct150 / Ct145 / Ct151

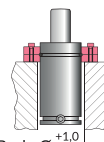

FC 120 A - FCQC 120

See p. Ct147 / Ct 149

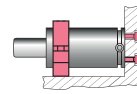

FSA 120  
 FSD 120

See p. Ct152 / Ct153

Standard: ISO 11901-3, VDI 3003-Blatt 3

| Code        | Cu<br>mm | L<br>mm | L min<br>mm | FO<br>Initial force<br>daN      | F <sub>1i</sub><br>End force*<br>daN | F <sub>1p</sub><br>End force*<br>daN | V0<br>cm <sup>3</sup> | ~Kg  | Maintenance kit<br>39BMRV0600C | PED<br>2014/68/EU |
|-------------|----------|---------|-------------|---------------------------------|--------------------------------------|--------------------------------------|-----------------------|------|--------------------------------|-------------------|
|             |          |         |             |                                 |                                      |                                      |                       |      |                                |                   |
| RV 6600-016 | 16       | 100     | 84          | 6630<br>± 5%<br>150bar<br>+20°C | 9141                                 | 10631                                | 298                   | 5,12 | •                              | •                 |
| RV 6600-019 | 19       | 106     | 87          |                                 | 9393                                 | 11022                                | 330                   | 5,23 | •                              | •                 |
| RV 6600-025 | 25       | 118     | 93          |                                 | 9799                                 | 11658                                | 394                   | 5,47 | •                              | •                 |
| RV 6600-032 | 32       | 132     | 100         |                                 | 10157                                | 12228                                | 469                   | 5,75 | •                              | •                 |
| RV 6600-038 | 38       | 144     | 106         |                                 | 10397                                | 12614                                | 533                   | 5,99 | •                              | •                 |
| RV 6600-050 | 50       | 168     | 118         |                                 | 10757                                | 13196                                | 661                   | 6,47 | •                              | •                 |
| RV 6600-063 | 63       | 194     | 131         |                                 | 11031                                | 13645                                | 799                   | 6,99 | •                              | •                 |
| RV 6600-075 | 75       | 218     | 143         |                                 | 11219                                | 13954                                | 927                   | 7,47 | •                              | •                 |
| RV 6600-080 | 80       | 228     | 148         |                                 | 11284                                | 14061                                | 980                   | 7,67 | •                              | •                 |
| RV 6600-100 | 100      | 268     | 168         |                                 | 11490                                | 14404                                | 1193                  | 8,46 | •                              | •                 |
| RV 6600-125 | 125      | 318     | 193         | 11669                           | 14703                                | 1459                                 | 9,46                  | •    | •                              |                   |

How to order: Code