

CILINDRO RV GAS SPRING RV

Mínima altura, máxima fuerza / Minimum height, maximum force

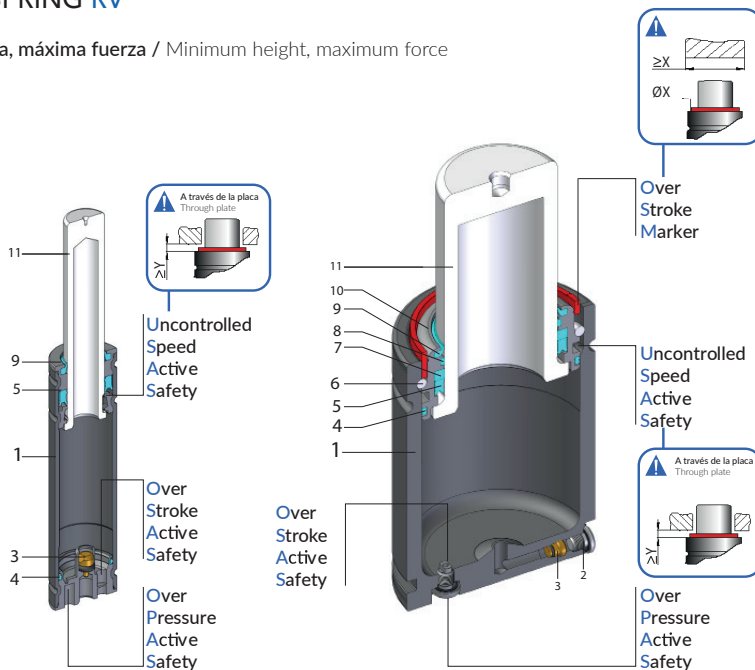

RV 170 - RV 320

RV 350 ÷ RV 20000

Standard: ISO, VDI

Model	Body \varnothing	Stroke Cu	Initial force F0	OSAS	USAS	OPAS	SKUDO	SW (optional)
	mm	mm	daN					
RV 170	19	7 - 125	170	•	•	•	-	•
RV 320	25	7 - 125	320	•	•	•	-	•
RV350	32	10 - 125	360	•	•	•	-	•
RV 500	38	10 - 125	470	•	•	•	-	•
RV 750	45	10 - 125	740	•	•	•	-	•
RV 1000	50	10 - 125	920	•	•	•	-	•
RV 1200	50	10 - 125	1060	•	•	•	-	•
RV 1500	63	10 - 125	1530	•	•	•	-	•
RV 2400	75	10 - 125	2385	•	•	•	-	•
RV 4200	95	16 - 125	4240	•	•	•	-	•
RV 6600	120	16 - 125	6630	•	•	•	-	•
RV 9500	150	19 - 125	9540	•	•	•	-	•
RV 12000	150	19 - 125	11780	•	•	•	-	•
RV 20000	195	19 - 125	19910	•	•	•	-	•

1	Cuerpo / Body
2	Válvula / Valve
3	Tapón / Plug
4	Anillo dual / Dual ring seal
5	Casquillo guía / Guide ring
6	Anillo de retención / Retaining ring

7	Retén / Rod seal
8	Anillo antiextrusión / Back-up ring
9	Rascador / Rod wiper
10	Casquillo / Bush
11	Vástago (nitrurado) / Rod (nitrited super finished)

CILINDRO RV
GAS SPRING RV

Versiones disponibles / Available versions

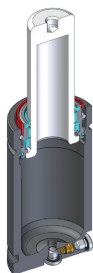

Standard code



GAS SPRING

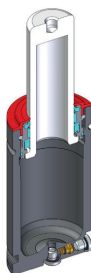

Standard code + W



GAS SPRING
+
Secondary wiper



See p. Ct163

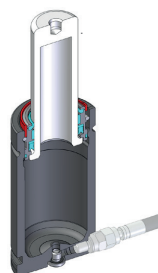

Standard code + N



Linkable
See p. Ct157

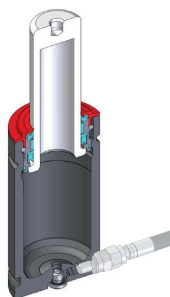

Standard code + N-W



Linkable
+
Secondary wiper



See p. Ct157 + Ct163

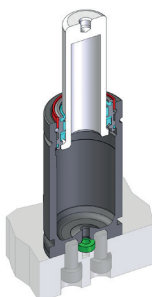

Standard code + E



Easy Manifold



See p. Ct158

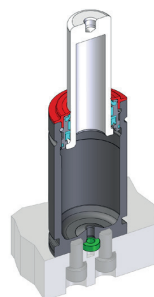

CILINDRO RV 750 GAS SPRING RV 750



SW

Active safety



OSAS



USAS



OPAS

* F_{1_i} = Isothermal end force at 100% Cu

* F_{1_p} = Polytrophic end force at 100% Cu

OSAS + OSM = OVER STROKE + OVER STROKE ACTIVE SAFETY MARKER

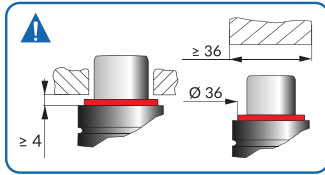

Assembly recommendation

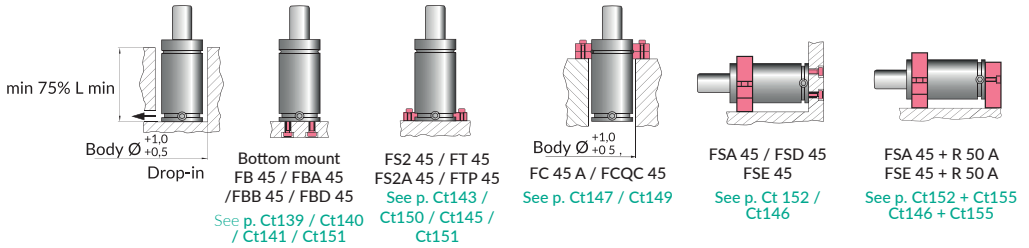
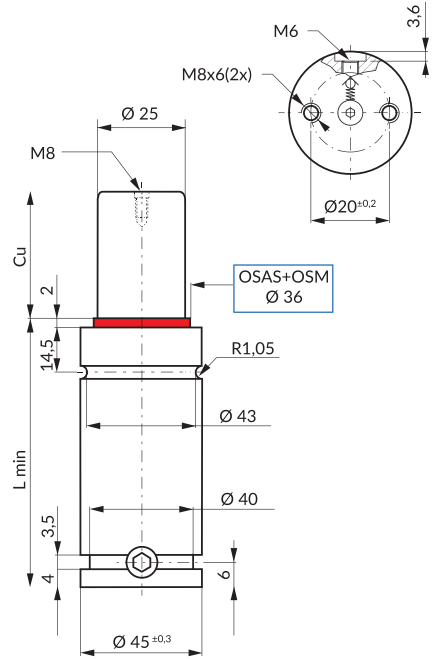

Standard: ISO 11901-3, VDI 3003-Blatt 3

Code	Cu mm	L mm	L min mm	FO Initial force daN	SPM ~20 -100 (at 20°)	Max Speed 1,8 m/s	Maintenance kit 39BMRV00750C	V0 cm³	~Kg	PED 2014/68/EU
RV 750-010	10	52	42	740 ± 5% 150bar +20°C	1118	1343	16,6	0,36	•	
RV 750-013	13	58	45		1152	1376	20,4	0,38	•	
RV 750-016	16	64	48		1176	1435	24,1	0,40	•	
RV 750-019	19	70	51		1194	1465	27,9	0,42	•	
RV 750-025	25	82	57		1220	1507	35,5	0,45	•	
RV 750-032	32	96	64		1240	1539	44,3	0,50	•	
RV 750-038	38	108	70		1251	1558	51,9	0,54	•	
RV 750-050	50	132	82		1267	1584	67	0,61	•	
RV 750-063	63	158	95		1278	1602	83,4	0,70	•	
RV 750-075	75	182	107		1285	1614	98,5	0,78	•	
RV 750-080	80	192	112		1287	1618	104,8	0,81	•	
RV 750-100	100	232	132		1294	1629	130,1	0,94	•	
RV 750-125	125	282	157		1300	1639	161,6	1,10	•	

How to order: Code