

CÁNCAMO GIRATORIO LATERAL CGA - CGAL
LATERAL SWIVEL EYEBOLT CGA - CGAL

STOCK

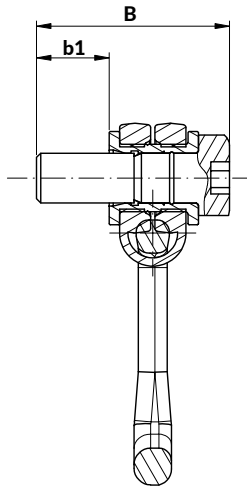

CGA

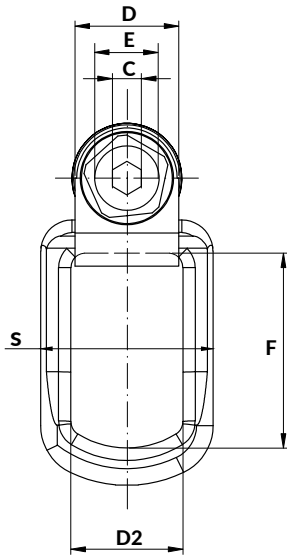

CGAL









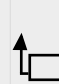
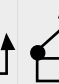

CE 2006/42/CE

M	D2	F (inner rings)	C	D	E	S	CGA		CGAL		DIAMETER OF RING	WEIGHT
							B	b1	B	b1		
M8	34,5	47	6	30	13	55	46	10,4	112	76	14	0,35
M10	34,5	47	6	30	17	55	52	15,4	133	96	14	0,35
M12	39,5	49	8	36	19	68	64	18	158	114	18	0,75
M14	40	49	10	36	22	68	66	21	185	140	18	0,75
M16	40	49	10	36	24	68	70	24	195	149	18	0,8
M18	53	72	12	50	30	83	83	26	237	180	16	1,25
M20	53	72	12	50	30	83	88	30	244	186	16	1,3
M24	54	87	14	50	36	83	95	35	281	221	18	1,45
M27	73	91	17	68	40	120	120	38	352	270	27	4,15
M30	73	91	17	68	46	120	132	48	360	278	27	4,2
M36	73	91	22	68	55	120	142	54	310	222	27	4,5
M42	94	126	24	85	64	148	176	72	368	264	31	7,7
M48	104	138	27	94	75	176	194	74	415	295	40	12,6

CÁNCAMO GIRATORIO LATERAL CGA - CGAL

LATERAL SWIVEL EYEBOLT CGA - CGAL

Reference	0°	90°	0°	90°	0-45°	45°-60°	0-45°	45-60°	Asymmetry	Asymmetry
										
	1 piece		2 pieces		2 pieces		3-4 pieces		2 pieces	3-4 pieces
	MAX. WORKING LOAD (t)									
M8	0,36	0,36	0,72	0,72	0,5	0,360	0,72	0,54	0,36	0,36
M10	0,63	0,63	1,25	1,25	0,85	0,630	1,3	0,9	0,63	0,63
M12	1	1	2	2	1,4	1	2,1	1,5	1	1
M14	1,2	1,2	2,4	2,4	1,7	1,2	2,5	1,8	1,2	1,2
M16	1,5	1,5	3	3	2,1	1,5	3,1	2,2	1,5	1,5
M18	2	2	4	4	2,8	2	4,2	3	2	2
M20	2,5	2,5	5	5	3,5	2,5	5,2	3,7	2,5	2,5
M24	4	4	8	8	5,6	4	8,4	6	4	4
M27	4	4	8	8	5,6	4	8,4	6	4	4
M30	5	5	10	10	7	5	10,5	7,5	5	5
M36	7	7	14	14	10	7	14,7	10,5	7	7
M42	10	10	20	20	14	10	21	15	10	10
M48	20	20	40	40	28	20	42	30	20	20

How to order: CGA+ M
CGAL + M