

# OREJETA DE TRANSPORTE OTB COMPLETE LIFTING BRACKET OTB

Material: St52

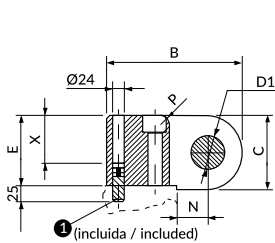

**i** Se recomienda montaje con tornillo TCC  
We recommend assembly with screw TCC



**Form A**

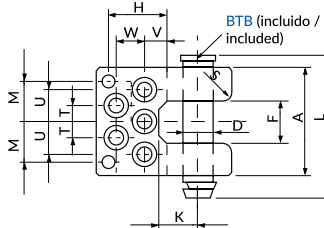

**Form B**

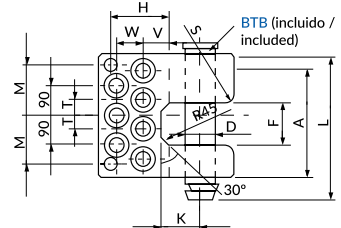

**Form C**

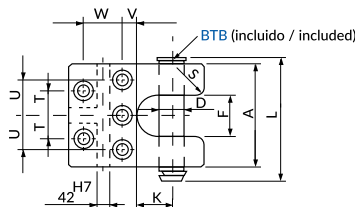
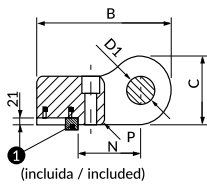

**Form D**

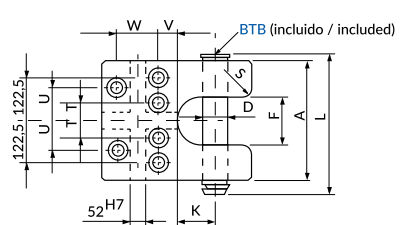

**1** Para formas A y B: muñequilla MQW / For shapes A and B: locating pin MQW  
Para formas C y D: chaveta CHO / For shapes C and D: key CHO

CE 2006/42/CE

Max. Load Kg	Max. Die weight Kg	A	B	C	D	D1	E	F	H	K	L	M	N	P	S	T	U	V	W	X	Form	Screw
3200	6400	126	185	80	30	32	75	50	85	-	158	45	40	12	16	20	40	30	35	40	A	M 16 x 80
5000	10000	150	210	100	40	42	95	60	87	-	187	52	50	12	20	22.5	45	25	40	60	A	M 20 x 100
8000	16000	175	240	120	50	52	115	75	95	-	220	62,5	60	16	24	25	50	35	45	80	A	M 24 x 120
12500	25000	200	300	140	60	62	130	80	145	-	246	77,5	65	20	30	35	65	60	65	95	A	M 36 x 160
18000	36000	250	300	160	80	82	150	100	105	-	305	100	90	20	30	30	60	30	60	115	B	M 30 x 160
25000	50000	300	435	200	80	82	140	120	-	115	360	-	199	30	30	70	100	45	125	-	C	M 36 x 160 (x5)
31500	63000	345	480	240	80	82	170	135	-	130	405	-	220	30	30	50	85	50	130	-	D	M 36 x 200 (x6)

How to order: OTB + Max. Load